

NEW  
JERSEY  
FUTURE

AMERICAN  
PLANNING  
ASSOCIATION  
NEW JERSEY

NEW JERSEY

# PLANNING & REDEVELOPMENT CONFERENCE 2022

VIRTUAL / IN-PERSON  
JUNE 14-15 / JUNE 16





At New Jersey Future, we believe that great places help build great lives. To help create and preserve our great places, we promote sensible and equitable planning, redevelopment, and infrastructure investments that foster vibrant cities and towns; protect natural lands and waterways; enhance transportation choices; support a strong economy; and provide access to safe, affordable, and aging-friendly neighborhoods for everyone. We do this through original research, innovative policy development, coalition-building, advocacy, community partnerships, and hands-on strategic assistance. Embracing differences and advancing fairness is central to our mission and operations, and we are firmly committed to pursuing greater justice, equity, diversity, and inclusion in our work and culture. New Jersey Future is located in downtown Trenton, NJ. Visit [www.njfuture.org](http://www.njfuture.org).



The New Jersey Chapter of the American Planning Association is an independent, not-for-profit organization that provides leadership in the development of vital communities by advocating excellence in community planning, promoting citizen empowerment, and providing the tools and support necessary to meet the challenges of growth and change. Through its educational and advocacy initiatives, the Chapter advances the art and science of good planning — physical, economic and social — to create communities that offer better and more equitable choices for how people work and live. Visit [www.njplanning.org](http://www.njplanning.org).

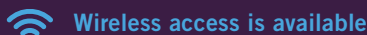

Network: @Hyatt\_Meeting

Username: **NJPRC22** Password: **NJPRC22**

Join the conversation! Tag New Jersey Future and APA New Jersey and use #NJPRC22



## WELCOME TO THE 2022 NEW JERSEY PLANNING AND REDEVELOPMENT CONFERENCE!

---

On behalf of New Jersey Future and the New Jersey Chapter of the American Planning Association, we are pleased to see everyone again in-person after hosting our joint conference virtually last year. This partnership offers an exciting opportunity to expand the quality programming we have offered independently in years' past—our organizations are proud to join together once again to offer timely topics delivered by an impressive lineup of diverse content leaders in the field.

We hope you have enjoyed the first two days of the conference which was offered virtually and will be available for you over the next three months. However, for many of us, we haven't seen each other in a long time so first and foremost, today we encourage you to use this time together to reconnect as we continue to recover, recharge, and reimagine land use in an ever-changing environment.

Redevelopment and comprehensive planning can help optimize efficiency, promote sustainable growth, bolster climate change resilience, and foster more just and equitable communities. Amid the ongoing pandemic and climate crisis, the implementation of innovative planning and redevelopment solutions has become more crucial than ever. **Together, we will build better, more inclusive, and equitable places where people live, work, and play.**



**PETER KASABACH**  
Executive Director  
New Jersey Future



**CHARLES W. LATINI, JR., AICP, PP**  
President  
APA New Jersey



**P O W E R I N G   P R O G R E S S**

EMPOWERING PEOPLE > POWERING LIFE

Powering our clean energy future is a priority for all of us. PSEG is committed to providing clean and sustainable energy that powers our customers' lives.



# PROGRAM OVERVIEW

Program and sponsor status as of June 6, 2022

TIME	AGENDA	LOCATION
8:00 AM	<b>REGISTRATION and CONTINENTAL BREAKFAST</b>	ATRIUM
9:00 AM	<p><b>PLENARY SESSION</b>  <i>Addressing Key Redevelopment Challenges and How New Federal Funding Will Help Get Us There</i></p> <ul style="list-style-type: none"> <li>■ <b>JANE COHEN</b>  <i>Executive Director, Governor's Office of Climate Action and the Green Economy</i></li> <li>■ <b>SHEILA OLIVER</b>  <i>Lieutenant Governor, State of New Jersey &amp; Commissioner, NJ Department of Community Affairs</i></li> <li>■ <b>PETER KASABACH</b>  <i>Executive Director, New Jersey Future</i></li> <li>■ <b>SHAWN LATOURETTE</b>  <i>Commissioner, New Jersey Department of Environmental Protection</i></li> <li>■ <b>TIM SULLIVAN</b>  <i>Chief Executive Officer, New Jersey Economic Development Authority</i></li> </ul>	REGENCY BALLROOM
10:30 AM	<b>NETWORKING BREAK</b>	ATRIUM
10:45 AM	<b>MORNING BREAKOUT SESSIONS</b>	BREAKOUT ROOMS
12:15 PM	<p><b>PLENARY</b>  <i>The Risk to Our Roofs: Considering and Harnessing the Housing-Climate Nexus</i></p> <ul style="list-style-type: none"> <li>■ <b>DANA BOURLAND</b>  <i>Senior Vice President, The JPB Foundation</i></li> <li>■ <b>GEORGEEN THEODORE</b>  <i>Professor, Hillier College of Architecture &amp; Design, New Jersey Institute of Technology</i></li> <li>■ <b>KELVIN BODDY</b>  <i>Director of Healthy Homes and Communities, Housing and Community Development Network of New Jersey</i></li> <li>■ <b>THOMAS DALLESSIO</b>  <i>Vice President of Policy, APA-NJ</i></li> </ul>	REGENCY BALLROOM
2:30 PM	<b>AFTERNOON BREAKOUT SESSIONS</b>	BREAKOUT ROOMS
3:45 PM	<b>CLOSING RECEPTION</b>	ATRIUM

*The New Jersey Planning & Redevelopment Conference has been approved for American Institute of Certified Planners (AICP) Certification Maintenance (CM) credits as well as mandatory topic credits for select sessions.*

*Individual sessions have also been approved for NJ Continuing Legal Education (CLE) credits and Continuing Educations Credits (CEU) for Certified Floodplain Managers.*

*Find more information on page 5.*



# RUTGERS

Edward J. Bloustein School  
of Planning and Public Policy



**World-class faculty. High-level professional and research staff.  
Dedicated support staff. Diverse and talented students.  
Active alumni.**

At the Bloustein School, we continually strive to expand our relevance in critical areas and meet the needs of the community at large. We foster a highly-collaborative academic, scholarly and professional environment, preparing students to be the planning, policy and health leaders of tomorrow, conducting cutting-edge, policy-relevant research and scholarship, cultivating leadership in public engagement and community service, and addressing the crucial policy issues of our time.

*To learn more about our programs or to schedule a visit, contact [recruit@ejb.rutgers.edu](mailto:recruit@ejb.rutgers.edu) or call (848) 932-4008*

## UNDERGRADUATE PROGRAMS

- B.S. Health Administration
- B.A. Planning and Public Policy
- B.S. Public Health
- B.S. Public Policy
- B.S. Urban Planning and Design

*in addition to offering minors in the above areas, we also offer minors in Public Administration and Management, Urban Studies, and Medical Ethics and Policy*

## GRADUATE DEGREE PROGRAMS

- Master of City and Regional Planning
- Master of Public Policy
- Master of Health Administration
- Master of Public Informatics
- Ph.D. in Planning and Public Policy

*as well as dual degrees in Business, Law, Global Affairs, Public Health, Infrastructure Planning, Food Economics and Social Work*

# bloustein.rutgers.edu

Edward J. Bloustein School of Planning and Public Policy | Rutgers, The State University of New Jersey  
33 Livingston Avenue | New Brunswick, New Jersey 08901

# CONTINUING EDUCATION CREDITS

---

The New Jersey Planning & Redevelopment Conference has been approved for the following professional continuing education units.

## AMERICAN INSTITUTE OF CERTIFIED PLANNERS (AICP)

---



All sessions have been approved for American Institute of Certified Planner (AICP) Certification Maintenance (CM) credits. Select sessions have also been approved for mandatory topic credits, including ethics, law, equity, and sustainability & resilience.

Certification  
Maintenance

## NJ CONTINUING LEGAL EDUCATION (CLE)

---



**New Jersey  
Builders Association**

Eleven sessions on June 16 have been approved for New Jersey Continuing Legal Education (CLE) credits, provided by the New Jersey Builders Association (1.3 CLE credits per session). To receive credits, participants must attend the entire

session and sign in and sign out on the attendance form provided for each eligible session. These forms will be submitted to the NJBA from the Conference Committee. The qualifying sessions are: **Historic Tax Credits: Combining Federal and State Programs for Community Development, The State of Housing in NJ, Safe Routes Everywhere and Safe Streets for All!, Redevelopment: Solving the Problems of Today, Creating the Communities of Tomorrow, Developers and DEI: Overcoming the Obstacles, Using the P-3 Approach for Public Projects, Right-Sizing It: The Challenges and Opportunities of Parking for Redevelopment Projects, Climate Blight: Using Redevelopment to Plan for and Address Climate Change, Challenges and Opportunities for EV Charging Facilities, and Puff-Puff or Pass: 70% of NJ Municipalities Still on the Cannabis Fence**

## CONTINUING EDUCATION CREDITS (CEU) FOR CERTIFIED FLOODPLAIN MANAGERS

---

Earn 6 CECs on Thursday, June 16 (in-person) from the Association of State Floodplain Managers.

**LEADERS IN ENVIRONMENTAL AND  
REDEVELOPMENT LAW, LITIGATION &  
*CLIMATE CHANGE RESILIENCY***

*Proud to Support  
New Jersey Future  
and  
APA - New Jersey*

The attorneys at Maraziti Falcon, LLP counsel public and private entities in meeting their transactional and operational needs in compliance with environmental, redevelopment and land use laws.



*Environmental and Redevelopment  
Law, Litigation &  
Climate Change Resiliency*

240 CEDAR KNOLLS ROAD, SUITE 301, CEDAR KNOLLS, NJ 07927  
(973) 912-9008 • FAX (973) 912-9007 • WWW.MFHLAW.COM

# PLENARY SESSIONS

9:00 AM

REGENCY BALLROOM

## **MORNING PLENARY: Addressing Key Redevelopment Challenges and How New Federal Funding Will Help Get Us There**

AICP CM | 1.5 | SR

**PLENARY SPONSORS:** GREENBAUM, ROWE, SMITH & DAVIS LLP, NEW JERSEY ECONOMIC DEVELOPMENT AUTHORITY, SOLAR LANDSCAPE

New Jersey is facing a number of inter-connected land use challenges that require coordinated action. This year, New Jersey will have billions of dollars coming through the federal pipeline for a myriad of land-use shaping projects. During this plenary session, we will hear from state executive branch officials about how the state intends to address cross-cutting land use issues like climate change adaptation, flooding, reducing vehicle miles traveled, and addressing the challenges of a growing logistics sector; and how these federal funds can best be used to support that work in the most efficient and equitable way.

- **JANE COHEN** *Executive Director*, Governor's Office of Climate Action and the Green Economy
- **SHEILA OLIVER** *Lieutenant Governor, State of New Jersey & Commissioner*, NJ Department of Community Affairs
- **SHAWN LATOURETTE** *Commissioner*, New Jersey Department of Environmental Protection
- **TIM SULLIVAN** *Chief Executive Officer*, New Jersey Economic Development Authority
- **PETER KASABACH** *Executive Director*, New Jersey Future (**Moderator**)

12:15 PM

REGENCY BALLROOM

## **AFTERNOON PLENARY: The Risk to Our Roofs: Considering and Harnessing the Housing-Climate Nexus**

AICP CM | 1.5 | SR

**PLENARY SPONSORS:** MCMANIMON, SCOTLAND & BAUMAN, LLC, PNC BANK

When you hear the word “crisis” nowadays, you probably tend to hear two different words that precede it: “housing” and “climate.” Though the former pertains to the built environment and the latter to the natural environment, the two are intertwined. We must consider how each affects the other, and take advantage of a joint solution in which tackling the housing crisis helps us buffer the climate crisis. This session will answer questions such as: “When it comes to climate change, how is housing critical to both mitigation and adaptation/resilience?” and “What should we do to prepare for the threats that our housing faces in the wake of more extreme weather events?”

- **DANA BOURLAND** *Senior Vice President*, The JPB Foundation
- **GEORGEEN THEODORE** *Professor*, Hillier College of Architecture & Design, New Jersey Institute of Technology
- **KELVIN BODDY** *Director of Healthy Homes and Communities*, Housing and Community Development Network of New Jersey
- **THOMAS DALLESSIO** *Vice President of Policy*, APA-NJ (**Moderator**)

# WE KEEP MAKING HEALTH CARE BETTER.

At Hackensack Meridian *Health*, excellence is the standard, where researchers fast-track breakthroughs into life-changing care. We're also sharing our clinical expertise through HealthU, providing much needed wellness information to the community, so you can live your healthiest life. We offer a full spectrum of services – from virtual appointments to treating the most complex conditions. Here, everyone works together to make you better.

**HackensackMeridianHealth.org**  
**844-HMH-WELL**



Hackensack  
Meridian *Health*

**KEEP GETTING BETTER**

[HackensackMeridianHealth.org](https://www.HackensackMeridianHealth.org)

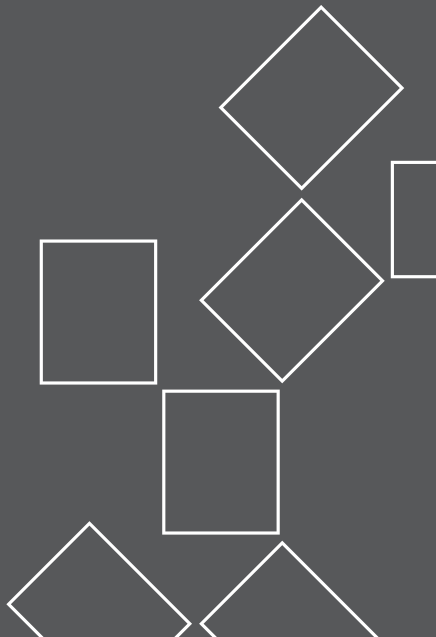

# WE TRANSFORM NEIGHBORHOODS



MULTI-FAMILY RESIDENTIAL

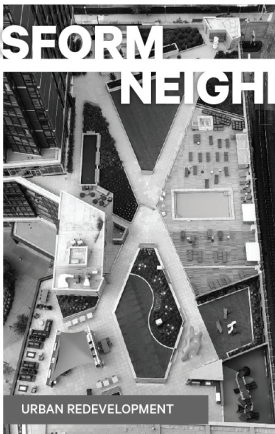

URBAN REDEVELOPMENT

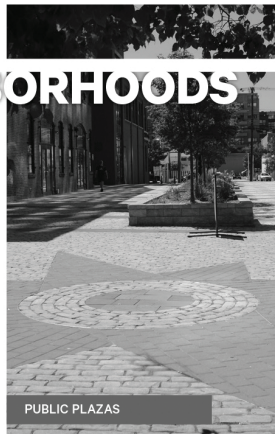

PUBLIC PLAZAS

We are an **Innovative land-use consultancy** providing creative solutions from **environmental due diligence** to **planning and design**, from **engineering** to **construction administration**. Our employees serve as your agents of change that through **strategy and execution** transform ideas into **results** across **New Jersey, New York and Pennsylvania**. Let's talk about your project today and how we will make your vision a reality.

**DRESDNER**  
**ROBIN**  
IDEAS THAT TRANSFORM

ENGINEERING  
ENVIRONMENTAL  
SURVEYING  
PLANNING  
LANDSCAPE ARCHITECTURE  
GEOSPATIAL ANALYSIS



# WE MEAN BUSINESS

New York • Newark • Jersey City • Basking Ridge • Philadelphia  
Genova Burns LLC • [www.genovaburns.com](http://www.genovaburns.com)

# FLOOR PLAN

## LOBBY LEVEL

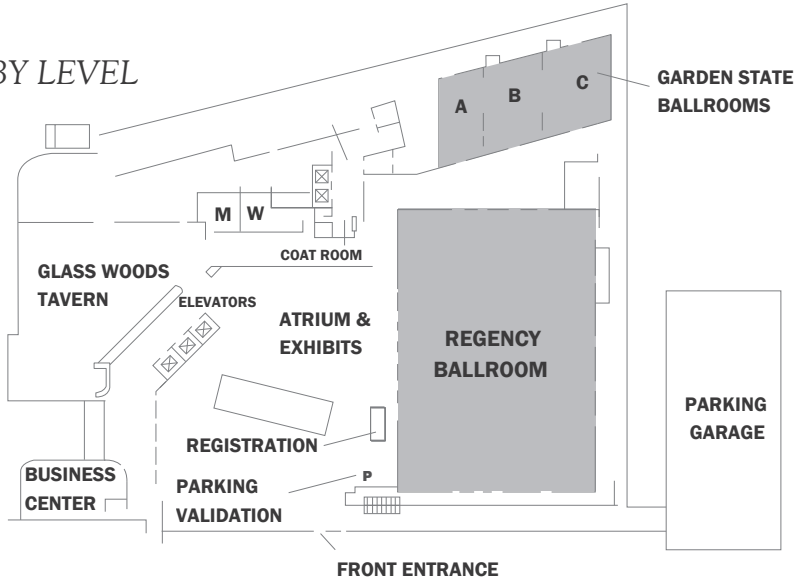

## SECOND FLOOR

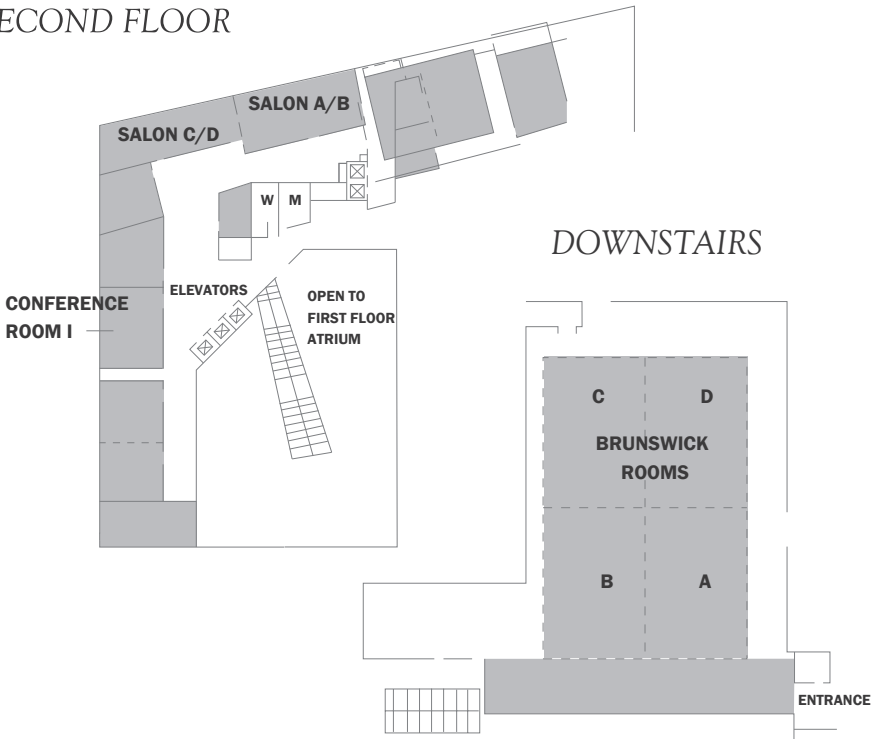

# SESSION SCHEDULE AT A GLANCE

Note: room assignments subject to change.

Detailed descriptions of each panel may be found on pages 13-23.

## MORNING PLENARY – 9:00 AM

**Addressing Key Redevelopment Challenges and How New Federal Funding Will Help Get Us There**

ROOM: REGENCY BALLROOM

## MORNING BREAKOUT SESSIONS – 10:45 AM

**Community Design for All Ages: A New Sustainable Jersey Action to Develop an Age-Friendly Plan**

ROOM: BRUNSWICK D  
TRACK: HOT TOPICS

**Historic Tax Credits: Combining Federal and State Programs for Community Development**

ROOM: GARDEN STATE A  
TRACK: INFRASTRUCTURE

**The State of Housing in NJ**

ROOM: BRUNSWICK B  
TRACK: LEGAL, TECHNICAL, AND FINANCIAL

**Downtown Raritan Sustainable Economic Development Plan: Putting the Plan in the Hands of the People**

ROOM: GARDEN STATE B  
TRACK: RESILIENCE AND SUSTAINABILITY

**Safe Routes Everywhere and Safe Streets for All!**

ROOM: SALON C/D  
TRACK: TRANSPORTATION AND MOBILITY

**Redevelopment Synergies: When Government Coordination and Private Development Interests Come Together**

ROOM: SALON A/B  
TRACK: PROFESSIONAL PRACTICE

**Democratizing Data: Data Tools for Building Trust and Sharing Power**

ROOM: GARDEN STATE C  
TRACK: EQUITY AND INCLUSION

**Redevelopment: Solving the Problems of Today, Creating the Communities of Tomorrow**

ROOM: BRUNSWICK A  
TRACK: PLANNING AND DEVELOPMENT

## AFTERNOON PLENARY – 12:15 PM

**The Risk to Our Roofs: Considering and Harnessing the Housing-Climate Nexus**

ROOM: REGENCY BALLROOM

## AFTERNOON BREAKOUT SESSIONS – 2:30 PM

**Location! Location! Location! The Economic Value and Benefits of Preserved Open Space**

ROOM: GARDEN STATE A  
TRACK: PLANNING AND DEVELOPMENT

**Developers and DEI: Overcoming the Obstacles**

ROOM: GARDEN STATE B  
TRACK: EQUITY AND INCLUSION

**Using the P-3 Approach for Public Projects**

ROOM: GARDEN STATE C  
TRACK: INFRASTRUCTURE

**Right-Sizing It: The Challenges and Opportunities of Parking for Redevelopment Projects**

ROOM: BRUNSWICK A  
TRACK: LEGAL, TECHNICAL, AND FINANCIAL

**Climate Blight: Using Redevelopment to Plan for and Address Climate Change**

ROOM: BRUNSWICK D  
TRACK: PLANNING AND DEVELOPMENT

**Challenges and Opportunities for EV Charging Facilities**

ROOM: SALON C/D  
TRACK: TRANSPORTATION AND MOBILITY

**Ethics and DEAI**

ROOM: SALON A/B  
TRACK: PROFESSIONAL PRACTICE

**Puff-Puff or Pass: 70% of NJ Municipalities Still on the Cannabis Fence**

ROOM: BRUNSWICK B  
TRACK: HOT TOPICS

CONFERENCE ROOM I, SALON A/B, SALON C/D: *Second Floor*  
GARDEN STATE A, B, C: *Lobby Level Outside Regency Ballroom*  
BRUNSWICK A, B, D: *Downstairs*

**Educational Sessions  
Featuring  
Greenbaum Panelists**

**Thursday, June 16  
2:30pm - 3:45pm**

**“Challenges and  
Opportunities for  
EV Charging Facilities”**



**Robert S. Goldsmith**  
Co-Chair | Redevelopment &  
Land Use Department

**“Right-Sizing It:  
The Challenges and  
Opportunities of Parking for  
Redevelopment Projects”**



**Steven G. Mlenak**  
Co-Chair | Redevelopment &  
Land Use Department

**Proud Sponsor  
of the  
2022 NJ  
Planning and  
Redevelopment  
Conference**

# MORNING BREAKOUT SESSIONS

10:45 AM

## COMMUNITY DESIGN FOR ALL AGES: A NEW SUSTAINABLE JERSEY ACTION TO DEVELOP AN AGE-FRIENDLY PLAN

AICP CM | 1.25 | SR

### HOT TOPICS

TRACK SPONSOR: INGLESINO, WEBSTER, WYCISKALA & TAYLOR, LLC

Our communities aren't designed for all ages. There isn't sufficient housing for people to downsize into as they age, transportation and walkability are low, and there's a health risk associated with social isolation people can experience when there aren't ways for them to engage in their communities or be self-sufficient and independent. A new Sustainable Jersey action to promote age-friendly community-building guides municipalities aiming to intentionally engage in age-friendly analysis, planning, and implementation as a component of equitable smart growth and sustainability. Learn about the new action and hear from individuals doing age-friendly and livability work in communities.

### ■ ERIK ESTRADA

*Community Manager, Community Foundation of South Jersey*

### ■ MARYJUDE HADDOCK-WEILER

*Planning Manager, New Jersey Highlands Council*

### ■ MEGHAN WREN, AICP, CFM

*Chair, Downe Township Green Team*

### ■ RANDALL SOLOMON

*Executive Director, Sustainable Jersey*

### ■ TANYA ROHRBACH

*Community Planning Manager, New Jersey Future*

## HISTORIC TAX CREDITS: COMBINING FEDERAL AND STATE PROGRAMS FOR COMMUNITY DEVELOPMENT

AICP CM | 1.25 | LAW, NJ CLE | 1.3

### INFRASTRUCTURE

TRACK SPONSOR: HANINI GROUP

Historic Tax Credit (HTC) Programs encourage private sector investment in rehabilitation and re-use of historic buildings. NJ's new Historic Property Reinvestment Program (HPRP) is a \$50 million competitive HTC program that can be used to leverage the federal HTC program to incentivize rehabilitation of identified historic properties. This session will focus on how the federal HTC and the HPRP will work together. Attendees will: gain an understanding of the type of projects that qualify for each of the programs, receive step-by-step guidance on the application process, and learn how to maximize benefits of HTCs by combining state and federal programs.

### ■ C. AIDITA MILSTED

*Director, Historic Preservation, New Jersey Economic Development Authority*

### ■ MICHAEL WIERZBICKI

*Senior Project Officer, Historic Preservation Department, New Jersey Economic Development Authority*

### ■ JENNIFER B. LEYNES

*Senior Historic Preservation Specialist, New Jersey Historic Preservation Office*

### ■ MICHAEL HANRAHAN

*Principal, Clarke Caton Hintz*

MORNING SESSIONS

MORE →

# MORNING BREAKOUT SESSIONS

---

## THE STATE OF HOUSING IN NJ

AICP CM | 1.25 | LAW, NJ CLE | 1.3

LEGAL, TECHNICAL AND FINANCIAL

TRACK SPONSOR: GENOVA BURNS LLC

New Jersey's constrained housing market, and the resulting lack of diversity of housing options for households throughout the income scale, continues to have negative impacts not only on our state's residents but also on corporate location decision making. Long-time residents fear that their kids won't be able to afford to stay in New Jersey, and employers worry about being able to recruit younger workers to a high-cost state. We need to better plan for how and where we facilitate growth and the creation of diverse, affordable housing options throughout New Jersey. As our state's population continues to grow, how will we meet this housing demand in a way that produces affordable options across the income spectrum in places that have the infrastructure to support growth and that let people walk, bike, and take public transit more? Hear from experts about current trends, policy fixes, and how redevelopment can play an important role in meeting this demand.

■ **ADAM GORDON**

*Executive Director, Fair Share Housing Center*

■ **DEBRA TANTLEFF**

*Founding Principal, Tantum Real Estate*

■ **DEBRA URBAN**

*Chief of Multifamily Programs, New Jersey Housing and Mortgage Finance Agency*

■ **TIFFANY HARRIS-DELANEY**

*Director of Policy, Planning and Development, City of East Orange*

■ **THOMAS STROWE**

*Director of Redevelopment, Township of Scotch Plains*

## DOWNTOWN RARITAN SUSTAINABLE ECONOMIC DEVELOPMENT PLAN: PUTTING THE PLAN IN THE HANDS OF THE PEOPLE

AICP CM | 1.25

RESILIENCE AND SUSTAINABILITY

TRACK SPONSOR: TD BANK

The Borough of Raritan suffers from the same problem many communities do: there was a small group of dedicated people working to improve the downtown, but they were burning out. While creating the Downtown Sustainable Economic Plan, the Borough established a citizen-oriented Plan Implementation Working Group. Presenters will highlight the innovative local economic development strategies; the all online community engagement effort; how the Borough identified new, interested participants for the Working Group; as well as the three-meeting process that established the Working Group. The session will include perspectives from the NJTPA/ MPO, Borough, consultant, and a member of the Working Group.

■ **ADAM TECZA**

*Planner & Urban Designer, FHI Studio*

■ **ANGELA KNOWLES**

*Deputy Director, Office of Planning Policy & Economic Development, Somerset County*

■ **BLYTHE EAMAN**

*Director, Environmental & Sustainability Planning, North Jersey Transportation Planning Authority*

■ **DEBRA THOMAS**

*Planning Board Chair, Borough of Raritan*

■ **DIANNE FRANCEL BAUTISTA**

*Founder, Raritan Together*

**SAFE ROUTES EVERYWHERE  
AND SAFE STREETS FOR ALL!**

AICP CM | 1.25 | LAW, NJ CLE | 1.3  
**TRANSPORTATION AND MOBILITY**  
**TRACK SPONSOR:** DRESDNER ROBIN

The recently passed Bipartisan Infrastructure Law includes \$6 billion in funding for a new Safe Streets for All program, an amazing opportunity for New Jersey. This session will highlight ways the Safe Streets for All concept is being used in NJ and showcase tools, resources, and opportunities to leverage partnerships to address safety, access, and connections to parks, trails, schools and community assets. Case study examples will include implementing a new vision for the state's Safe Routes program, inclusive trail planning for the Circuit Trails Network, the Connect to Walk program in Morris County, and efforts to implement Vision Zero.

- **DENISE LANZA**  
*Assistant Deputy Director, Morris County Park Commission*
- **ELEANOR HORNE**  
*Co-President, Lawrence Hopewell Trail Corporation*
- **SANGEETA BADLANI**  
*Founding Member, Nikhil Badlani Foundation*
- **SEAN MEEHAN**  
*Senior Research Specialist, Alan M. Voorhees Transportation Center, Rutgers University*

**REDEVELOPMENT SYNERGIES:  
WHEN GOVERNMENT COORDINATION  
AND PRIVATE DEVELOPMENT  
INTERESTS COME TOGETHER**

AICP CM | 1.25 | LAW, NJ CLE | 1.3  
**PROFESSIONAL PRACTICE**  
**TRACK SPONSOR:** PHOENIX ADVISORS, LLC  
**SESSION SPONSOR:** NEW JERSEY AMERICAN WATER

Redevelopment works best when the controlling governmental body and the private redeveloper are on the same page. This session will explore several case studies that demonstrate key success factors in making complicated redevelopment projects work. What was the role of the government entity and what did they do to set the table for redevelopment? How did the private developer work with the government entity to move the project forward?

- **JOHN INGLESINO**  
*Managing Partner, Inglesino, Webster, Wyciskala & Taylor, LLC*
- **CHRISTOPHER A. BROWN**  
*Community Development Director, City of Hoboken*
- **DARRYL GODFREY**  
*Chief Operating Officer, New Jersey Redevelopment Authority*
- **JOSEPH MARAZITI**  
*Partner, Maraziti Falcon LLP*
- **SHERRY TRACEY**  
*Managing Director, Phoenix Advisors LLC*

MORNING SESSIONS

MORE →



ECONOMIC DEVELOPMENT AUTHORITY

# Supporting equitable development and growth that aligns with communities' priorities



ASPIRE

BROWNFIELDS LOAN PROGRAM

HISTORIC PROPERTY REINVESTMENT PROGRAM

CLEAN ENERGY PROGRAMS

COMMUNITY DEVELOPMENT PROGRAMS

CHILDCARE FACILITIES IMPROVEMENT PROGRAM



To learn more, visit [www.NJEDA.com](http://www.NJEDA.com) or email [NJEDA@njeda.com](mailto:NJEDA@njeda.com)



**DEMOCRATIZING DATA:  
DATA TOOLS FOR BUILDING  
TRUST AND SHARING POWER**

AICP CM | 1.25  
**EQUITY AND INCLUSION**  
**TRACK SPONSOR:** VALLEY BANK

Data is powerful. Accessible and transparent data can be transformative and play a vital role in achieving equity. Data, when easily accessible and usable, can bridge silos, fuel questions, and distribute power to communities. With increased data transparency, people can become more aware of challenges and issues related to infrastructure and more connected to different types of infrastructure that support healthy communities. This session will describe several tools that have made data more accessible and transparent so that it can be understood and used by more people. Data transparency tools include Jersey WaterCheck, the Water Equity Risk Map, and Conservation Blueprint. The session will also include examples of advocates using data to implement change.

- **ELIZABETH DRAGON**  
*Assistant Commissioner, Community Investment and Economic Revitalization, New Jersey Department of Environmental Protection*
- **JOHN HASSE**  
*Director, Geospatial Research Lab, Rowan University*
- **JYOTI VENKETRAMAN**  
*Program Manager, New Jersey Future*
- **TENISHA MALCOLM**  
*Director, Urban Mayors Policy Center, John S. Watson Institute, Kean University*

**REDEVELOPMENT:  
SOLVING THE PROBLEMS OF  
TODAY, CREATING THE  
COMMUNITIES OF TOMORROW**

AICP CM | 1.25 | LAW, NJ CLE | 1.3  
**PLANNING AND DEVELOPMENT**  
**TRACK SPONSOR:** T&M ASSOCIATES

Join our panel of women leaders in the redevelopment industry as their share experience and insights in using redevelopment tools to solve the problems of today and create the communities of tomorrow. It's a common misconception that redevelopment is only useful in our urban centers. Our panelists will share how they have used redevelopment in all areas of our State, from the shore to the Highlands to our cities, to improve infrastructure, incentivize public spaces and affordable housing, and create jobs.

- **ANNISIA CIALONE**  
*Director of Housing and Economic Development, City of Jersey City*
- **JENNIFER CREDIDIO**  
*Member of the Firm, McManimon, Scotland & Baumann, LLC*
- **JESSICA CALDWELL, PP, AICP, LE**  
*Principal Planner, J. Caldwell & Associates*
- **TANYA MARIONE**  
*Planning Director, City of Jersey City*
- **VALERIE JACKSON**  
*Director, Department of Economic Development, City of Plainfield*

MORNING SESSIONS

# hanini

Building the future, while celebrating the past.



## PHOENIX ADVISORS, LLC

EXPERTS IN REDEVELOPMENT

**Sherry Tracey**

Senior Managing Director

**609.291.0130**

# AFTERNOON BREAKOUT SESSIONS

2:30 PM

## **LOCATION! LOCATION! LOCATION! THE ECONOMIC VALUE AND BENEFITS OF PRESERVED OPEN SPACE**

AICP CM | 1.25

### **PLANNING AND DEVELOPMENT**

**TRACK SPONSOR:** NEW JERSEY REDEVELOPMENT AUTHORITY

Mercer County's 30-year land preservation efforts have measurable economic benefits, demonstrated in a recent Return on Environment study. Mercer County is a microcosm of the State, with a diverse population and landscape. In response to development pressure the County initiated an aggressive preservation effort resulting in the preservation of 27% of its land area. This study estimated the economic benefits of protected open space, measuring the impact of: property values, economic activity, environmental benefits, and recreation and health. The panel will look at the study findings through an equity lens. The County's voter-approved referenda have evolved to reflect changing conditions.

■ **ELEANOR HORNE**

*Co-President, Lawrence Hopewell Trail Corporation*

■ **JOHN S. WATSON, JR.**

*Co-Executive Director, New Jersey Conservation Foundation*

■ **LESLIE R. FLOYD, AICP, PP**

*Director, Mercer County Planning Department*

■ **STEVEN WRAY**

*Senior Vice President and Principal, Econsult Solutions, Inc.*

## **DEVELOPERS AND DEI: OVERCOMING THE OBSTACLES**

AICP CM | 1.25 | L | NJ CLE | 1.3

### **EQUITY AND INCLUSION**

**TRACK SPONSOR:** VALLEY BANK

A good portion of development in New Jersey is located in urban centers where the community may not look like the developers and investors seeking to build. The development community has long needed to reckon with the challenges that divide communities, whether by race, gender, affiliation or economic status. This session invites developers and professionals of all stripes to have a direct discussion on the challenges that people of color and/or women face when they are working as developers. This session will include a diverse panel who will discuss these challenges and ways to improve the atmosphere for the next generation.

■ **ADENAH BAYOH**

*Founder, Adenah Bayoh and Company;  
Multi-IHOP Owner, Foya Foods*

■ **ADRIAN MAPP**

*Mayor, Plainfield*

■ **JONG SOOK NEE**

*Member, Nee Plata Law LLC*

■ **PATRICK TERBORG**

*Managing Member, TD+Partners*

AFTERNOON SESSIONS

MORE →

### **USING THE P-3 APPROACH FOR PUBLIC PROJECTS**

AICP CM | 1.25 | LAW, NJ CLE | 1.3

#### **INFRASTRUCTURE**

**TRACK SPONSOR:** HANINI GROUP

**SESSION SPONSOR:** CHIESA SHAHINIAN & GIANTOMASI PC

“Public-Private Partnership agreements, commonly known as P3, can be a more effective way to undertake public building and infrastructure projects. The panel will explain how P3 projects work including the two primary approaches and provide examples of successful application of the P3 principles. This is a session planners and public officials will find enlightening, especially if there are any larger scale public projects on your horizon in the coming months or years.”

■ **ANTHONY P. MERCANTANTE, AICP, PP**

*Administrator, Middletown Township*

■ **ERIC MOORE**

*President, Brandywine Financial Services*

■ **SANYOGITA CHAVAN, AICP, PP**

*Practice Leader, H2M architects and engineers*

■ **TONY PERRY**

*Mayor, Middletown Township*

### **RIGHT-SIZING IT: THE CHALLENGES AND OPPORTUNITIES OF PARKING FOR REDEVELOPMENT PROJECTS**

AICP CM | 1.25 | LAW, NJ CLE | 1.3

#### **LEGAL, TECHNICAL AND FINANCIAL**

**TRACK SPONSOR:** GENOVA BURNS LLC

They say that the best referee is the one you don't notice. The same could be said for parking. When it's right sized and well located, nobody notices. When it's not, however, it can mean the downfall of the project and can taint that community's appetite for future progress. This seminar explores the challenges facing municipalities and developers alike in designing smart parking programs. The panel will discuss the anticipated revisions to the outdated RSIS parking standards, changes in the ways society parks now and in the future, shared parking, and public private partnership opportunities driven by parking.

■ **CHUCK OLIVO**

*Principal/Professional Engineer, Stonefield Engineering and Design*

■ **CLINTON CALABRESE**

*Assemblyman, New Jersey General Assembly*

■ **DEBBIE ALAIMO LAWLOR, FAICP, PP**

*Discipline Leader-Planning, Colliers Engineering & Design*

■ **STEVEN MLENAK**

*Co-Chair, Redevelopment & Land Use Department, Greenbaum, Rowe, Smith & Davis LLP*

■ **VALERIE JACKSON**

*Director, Department of Economic Development, City of Plainfield*

## **CLIMATE BLIGHT: USING REDEVELOPMENT TO PLAN FOR AND ADDRESS CLIMATE CHANGE**

AICP CM | 1.25 | L | NJ CLE | 1.3  
**RESILIENCE AND SUSTAINABILITY**  
**TRACK SPONSOR: TD BANK**

This session will provide an overview of how redevelopment and the powers provided to municipalities in the Local Redevelopment and Housing Law can be used to plan for and address climate change-related hazards and promote resiliency in communities throughout New Jersey. Panelists will discuss the impact of climate change on socially vulnerable populations and how redevelopment plans can be crafted to address environmental justice issues.

- **CHARLES HEYDT**  
*Director of Planning, Dresdner Robin*
- **DAVID ROBERTS, PP, AICP**  
*Township Planner/Division Director - Planning & Zoning, Toms River Township*
- **MRUNMAYEE ATRE, AICP, PP, LEED GA, CAPM**  
*Associate, Nishuane Group*
- **NICK ANGARONE, PP, AICP**  
*Chief Climate Resilience Officer, New Jersey Department of Environmental Protection*
- **STAN SLACHETKA, FAICP, PP**  
*Planning Group Manager, T&M Associates*

## **CHALLENGES AND OPPORTUNITIES FOR EV CHARGING FACILITIES**

AICP CM | 1.25 | LAW, NJ CLE | 1.3  
**TRANSPORTATION AND MOBILITY**  
**TRACK SPONSOR: DRESDNER ROBIN**

The panel includes speakers that represent various stakeholders involved in the planning of EV charging stations. The speakers on this panel include representatives from Parking Authorities, Planners, Consultants, and more to encompass the planning process from all stakeholders. The panel will aim to make listeners aware of the challenges that are faced, as well as the opportunities and benefits that are available when installing EV charging in various locations, including public parking facilities.

- **BOB GOLDSMITH**  
*Co-Chair, Redevelopment & Land Use Department, Greenbaum, Rowe, Smith & Davis LLP*
- **CAROLINE MCCALLUM**  
*Program Manager, NJ Clean Cities/Greener by Design*
- **KATHARINA MIGUEL**  
*Clean Energy Manager, Isles Inc.*
- **MARIA CONNOLLY**  
*Principal Planner, NJ Department of Community Affairs, Local Planning Services*

**MORE →**

Every day, you  
bring us one step  
closer to where  
we want to be.



New Jersey Future and The American Planning Association-New Jersey Chapter are proof that today can make a world of a difference when committing to change. We're proud to be a part of what you do.

**Contact Yolanda Swiney**

Vice President | Community Consultant  
yolanda.swiney@pnc.com  
pnc.com/communitydevelopmentbanking



©2022 The PNC Financial Services Group, Inc. All rights reserved. PNC Bank, National Association. Member FDIC  
CON PDF 0618-0106

## ETHICS AND DEAI

AICP CM | 1.25 | ETHICS

### PROFESSIONAL PRACTICE

TRACK SPONSOR: PHOENIX ADVISORS, LLC

This session will explore ethical scenarios that focus on diversity, equity, accessibility, and inclusion in the planning profession. It will highlight Section A.1.e and Section A.3 of the AICP Code of Ethics, which speak to the role of social justice and equity in planning practice. The session will include an overview of the Code and apply it to ethical scenarios relevant to practitioners.

#### ■ CHRISTOPHER A. BROWN

*Community Development Director,  
City of Hoboken*

#### ■ COURTENAY MERCER

*Principal, Mercer Planning Associates*

## PUFF-PUFF OR PASS: 70% OF NJ MUNICIPALITIES STILL ON THE CANNABIS FENCE

AICP CM | 1.25 | LAW, NJ CLE | 1.3

### HOT TOPICS

TRACK SPONSOR: INGLESINO, WEBSTER,  
WYCISKALA & TAYLOR, LLC

The session will explore the nature of state regulation and how it has influenced municipal decision-making and the opportunities that remain. As nearly 70% of the state's municipalities have opted out, find out the real story behind this phenomenon as the state overwhelmingly past legalization in the 2020 ballot referendum and how municipalities might work to alleviate constituent concerns and utilize their constitutional power to zone to take advantage of the jobs and revenue that this new industry will bring. Discussion regarding social equity will also be included as barriers to entry for New Jersey citizens most impacted by the war on drugs remain a real concern as the panel explores what can we do collectively through public-private partnership to address this important issue?

#### ■ CHARLES LATINI

*Managing Partner, InFIELD Cannabis Group*

#### ■ DARRIN CHANDLER JR.

*Owner, Premium Genetics*

#### ■ JANICE KOVACH

*Mayor, Town of Clinton*

#### ■ MIKE MCQUEENY

*Counsel, Foley Hoag*

THE EASTERN  
TRANSPORTATION  
COALITION  
MBUF WORK



## Help us explore the future of transportation in New Jersey!

The Eastern Transportation Coalition, in partnership with the New Jersey Department of Transportation, needs your help to explore an alternative approach to transportation funding called a Mileage-Based User Fee (MBUF). An MBUF means drivers pay for the miles they drive instead of the fuel they buy. **The Coalition is conducting an MBUF Pilot Program in New Jersey, and they want you to join and tell them about your experience.** It's easy, and there are no fees to participate.

### How to Participate in the Pilot



ENROLL



INSERT



DRIVE



RETURN

1. **Enroll** - Fill out the enrollment form by clicking the link on the website.
2. **Insert** - Plug a small device into your vehicle to record mileage.
3. **Drive** - Then drive as you normally do.
4. **Return** - After a few months, mail back the device.

*These steps may vary depending on the mileage-reporting option selected.*



Visit [NewJerseyMBUFpilot.com](https://NewJerseyMBUFpilot.com) to enroll now!  
Individuals who qualify can get paid up to \$100 for participating.



609-293-7800



[newjersey@mbufpilot.org](mailto:newjersey@mbufpilot.org)

# SPEAKERS

## THANK YOU TO OUR 2022 NEW JERSEY PLANNING AND REDEVELOPMENT CONFERENCE SPEAKERS JUNE 14-16

### **KAREEM ADEEM**

*Director, Newark Department of Water and Sewer Utilities*

### **LESLIE ANDERSON**

*President & CEO, New Jersey Redevelopment Authority*

### **NICK ANGARONE, PP, AICP**

*Chief Climate Resilience Officer, New Jersey Department of Environmental Protection*

### **MRUNMAYEE ATRE, AICP, PP, LEED GA, CAPM**

*Associate, Nishuane Group*

### **SANGEETA BADLANI**

*Founding Member, Nikhil Badlani Foundation*

### **VANESSA BARRIOS**

*Manager of Advocacy Programs, Regional Plan Association*

### **DIANNE FRANCEL BAUTISTA**

*Founder, Raritan Together*

### **ADENAH BAYOH**

*Founder, Adenah Bayoh and Company; Multi-IHOP Owner; Foya Foods*

### **ARIANE BENREY**

*Solar Manager, Division of Clean Energy, New Jersey Board of Public Utilities*

### **ARIELLE BERNARD**

*Organics Waste Solutions Manager, WM*

### **KIMBERLY BIRDSALL, MPH**

*Executive Director, Health Coalition of Passaic County*

### **MARY BLANUSA**

*Executive Director, Northern New Jersey Community Foundation*

### **KELVIN BODDY**

*Director of Healthy Homes and Communities, Housing and Community Development Network of New Jersey*

### **DANA BOURLAND**

*Senior Vice President, The JPB Foundation*

### **CHRISTOPHER A. BROWN**

*Community Development Director, City of Hoboken*

### **RACHEL BROWN**

*Project Coordinator, Alan M. Voorhees Transportation Center, Rutgers University*

### **DR. HOWARD BURRELL**

*Mayor, Vernon Township*

### **CLINTON CALABRESE**

*Assemblyman, New Jersey General Assembly*

### **JESSICA CALDWELL, P.P., A.I.C.P., L.E.**

*Principal Planner, J. Caldwell & Associates*

### **PAUL CEPPI**

*Vice President, Tax Credits and Financing, New Jersey Economic Development Authority*

Planning and design of livable, sustainable  
and enduring communities



## Clarke Caton Hintz

Architecture • Planning • Landscape Architecture  
Trenton NJ • 609 883 8383 • [clarkecatonhintz.com](http://clarkecatonhintz.com)



Find us on    

## Powerful leadership

We believe in working together to build a strong  
and sustainable community for all.



**FirstEnergy**  
Foundation

# SPEAKERS

---

**DARRIN CHANDLER JR.**

*Owner, Premium Genetics*

**SANYOGITA CHAVAN, AICP, PP**

*Practice Leader,*

*H2M architects + engineers*

**OWEN CHRISTENSEN**

*Project Manager, Transit Oriented*

*Development, Real Estate and*

*Economic Development, NJ Transit*

**ANNISIA CIALONE**

*Director of Housing and Economic*

*Development, City of Jersey City*

**JANE COHEN**

*Executive Director, Governor's Office of*

*Climate Action and the Green Economy*

**SHEENA COLLUM**

*Executive Director, APA New Jersey*

**MARIA CONNOLLY**

*Principal Planner, NJ Department of*

*Community Affairs, Local Planning Services*

**TAI COOPER**

*Chief Community Development*

*Officer, New Jersey Economic*

*Development Authority*

**HEATHER COOPER, MPA**

*Deputy Mayor, Evesham Township*

**JENNIFER CREDIDIO**

*Member, McManimon,*

*Scotland & Baumann, LLC*

**THOMAS DALLESSIO**

*Vice President, Policy APA-NJ*

**APRIL DE SIMONE**

*Principal, Trahan Architects*

**MICHELE DELISFORT**

*Principal and Managing Partner,*

*Nishuane Group, LLC*

**WILDA DIAZ**

*Mayor (former), City of Perth*

*Amboy; former Chair, Perth Amboy*

*Redevelopment Agency*

**STEPHANIE DIPETRILLO**

*Senior Researcher, Alan M.*

*Voorhees Transportation Center,*

*Rutgers University*

**ELIZABETH DRAGON**

*Assistant Commissioner, Community*

*Investment and Economic Revitalization*

*New Jersey, Department of*

*Environmental Protection*

**BLYTHE EAMAN**

*Director, Environmental &*

*Sustainability Planning, North Jersey*

*Transportation Planning Authority*

**OMAYRA ECHENIQUE**

*Director of Development, RBH Group*

**ERIK ESTRADA**

*Community Manager, Community*

*Foundation of South Jersey*

**RICHARD EZIKE, PHD**

*Director of Infrastructure and*

*Planning, CHPlanning Limited*

**LESLIE R. FLOYD, AICP, PP**

*Director, Mercer County*

*Planning Department*

**TOBIAS FOX**

*Managing Director,*

*Newark Science and Sustainability*

# SPEAKERS

---

**VIVIAN FRASER**

*President & CEO, Urban League  
of Essex County*

**NIEVES G. PIMIENTA**

*Outreach Manager, Alan M.  
Voorhees Transportation  
Center Rutgers University*

**ELENA GABLE, PP, AICP, CFM**

*Principal Planner, Heyer,  
Gruel & Associates*

**JIM GILBERT**

*Board Member, New Jersey Future;  
Board of Trustees and former Chair,  
State Planning Commission*

**DARRYL GODFREY**

*Chief Operating Officer, New Jersey  
Redevelopment Authority*

**BOB GOLDSMITH**

*Co-Chair, Redevelopment & Land  
Use Department, Greenbaum,  
Rowe, Smith & Davis LLP*

**AMANDA GONZALEZ**

*Domestic Violence Advocate,  
Women Rising, Inc.*

**JAIRO GONZALEZ**

*President and Trustee,  
NJ Composting Council*

**JENNIFER GONZALEZ**

*Director of Environmental Services  
and Chief Sustainability Officer,  
City of Hoboken*

**ADAM GORDON**

*Executive Director,  
Fair Share Housing Center*

**SERPIL GURAN**

*Director, Rutgers EcoComplex,  
Rutgers University*

**MARYJUDE HADDOCK-WEILER**

*Planning Manager, New Jersey  
Highlands Council*

**KEITH HAMAS**

*Principal Planner, Safety Planning,  
North Jersey Transportation  
Planning Authority*

**MICHAEL HANRAHAN**

*Principal, Clarke Caton Hintz*

**TIFFANY HARRIS-DELANEY**

*Director of Policy, Planning and  
Development, City of East Orange*

**JOHN HASSE**

*Director, Geospatial Research Lab,  
Rowan University*

**CHARLES HEYDT**

*Director of Planning, Dresdner Robin*

**PATRICIA HIGH**

*Assistant Public Health Coordinator,  
Ocean County Health Department*

**ELEANOR HORNE**

*Co-President, Lawrence Hopewell  
Trail Corporation*

**MELANIE HUGHES MCDERMOTT**

*Senior Researcher, Sustainable  
Jersey at the Sustainability Institute,  
The College of New Jersey*

**KARIM HUTSON**

*Founder & Managing Member,  
Genesis Companies*

# SPEAKERS

---

## **JOHN INGLESINO**

*Managing Partner, Inglesino, Webster, Wyciskala & Taylor, LLC*

## **VALERIE JACKSON**

*Director, Department of Economic Development, City of Plainfield*

## **STEVE JOBIN**

*President/CEO, Raritan Bay Area YMCA*

## **PETER KASABACH**

*Executive Director, New Jersey Future*

## **KATELYN KATZER**

*Principal Planner/SCADB Administrator, Somerset County Planning Division*

## **JOHN KELLER**

*Co-Producer & Director of Education, coLAB Arts*

## **JIM KERN**

*Commissioner, Warren County Board of Commissioners*

## **MARY KIMBALL**

*Urban and Community Resilience Team Leader, Arcadis*

## **ANGELA KNOWLES**

*Deputy Director, Office of Planning Policy & Economic Development, Somerset County*

## **MICHAEL KOLBER**

*Senior Planner, City of Trenton*

## **JANICE KOVACH**

*Mayor, Town of Clinton*

## **ALLISON LADD**

*Deputy Mayor/Director, Department of Economic and Housing Development, City of Newark*

## **JEROMIE LANGE**

*Director of Development, Active Acquisitions LLC*

## **DENISE LANZA**

*Assistant Deputy Director, Morris County Park Commission*

## **CHARLES LATINI**

*Managing Partner, InFIELD Cannabis Group*

## **SHAWN LATOURETTE**

*Commissioner, New Jersey Department of Environmental Protection*

## **DEBBIE ALAIMO LAWLOR, FAICP, PP**

*Discipline Leader-Planning, Colliers Engineering & Design*

## **LISA LEE**

*Deputy Director, Bike & Pedestrian Programs, EZ Ride*

## **JENNIFER B. LEYNES**

*Senior Historic Preservation Specialist, New Jersey Historic Preservation Office*

## **PATRICIA LINDSAY-HARVEY**

*Chair, Willingboro Green Team*

## **GABRIEL MAHON**

*Chief, Bureau of NJPDES, Stormwater Permitting and Water Quality Management, New Jersey Department of Environmental Protection*



RowanUniversity

**Proudly supporting  
New Jersey Future,  
APA-NJ and excellence  
in planning for beautiful,  
functional and successful  
communities.**

Our dedicated and caring faculty lead our M.S. degree in Urban and Regional Planning, offering specialized coursework in planning communication, food systems, GIS and sustainability studies.

**Plan your future, begin today.  
[go.rowan.edu/planning](http://go.rowan.edu/planning)**

# SPEAKERS

---

## **TENISHA MALCOLM**

*Director, Urban Mayors Policy Center,  
John S. Watson Institute, Kean University*

## **DEBBIE MANS**

*Partner, TWENTYTWENTY  
Public Affairs*

## **ADRIAN MAPP**

*Mayor, Plainfield*

## **JOSEPH MARAZITI**

*Partner, Maraziti Falcon LLP*

## **TANYA MARIONE**

*Planning Director, City of Jersey City*

## **CAROLINE MCCALLUM**

*Program Manager, NJ Clean  
Cities/Greener by Design*

## **PAUL MCEVILY**

*Executive Director, Interfaith Neighbors*

## **MIKE MCQUEENY**

*Counsel, Foley Hoag*

## **SEAN MEEHAN**

*Senior Research Specialist,  
Alan M. Voorhees Transportation Center,  
Rutgers University*

## **MARITZA E. MERCADO**

*Pechin Deputy Director, Equitable  
Development, City of Richmond, VA*

## **ANTHONY P. MERCANTANTE, AICP, PP**

*Administrator, Middletown Township*

## **COURTENAY MERCER**

*Principal, Mercer Planning Associates*

## **KATHARINA MIGUEL**

*Clean Energy Manager, Isles Inc.*

## **C. AIDITA MILSTED**

*Director, Historic Preservation,  
New Jersey Economic  
Development Authority*

## **STEVEN MLENAK**

*Co-Chair, Redevelopment &  
Land Use Department, Greenbaum,  
Rowe, Smith & Davis LLP*

## **CARLETON MONTGOMERY**

*Executive Director, Pinelands  
Preservation Alliance*

## **ERIC MOORE**

*President, Brandywine  
Financial Services*

## **PERI NEARON**

*Executive Director, Division of  
Disability Services, New Jersey  
Department of Human Services*

## **JONG SOOK NEE**

*Member, Nee Plata Law LLC*

## **KENDRA NELSON**

*Transportation Planner, Delaware Valley  
Regional Planning Commission*

## **RUTH ANN NORTON**

*President & CEO, Green &  
Healthy Homes Initiative*

## **SHEILA OLIVER**

*Lieutenant Governor, State of  
New Jersey & Commissioner NJ  
Department of Community Affairs*

## **CHUCK OLIVO**

*Principal/Professional Engineer,  
Stonefield Engineering and Design*

295J  
Jersey City, NJ



One Thompson Ave.  
Dover, NJ

1971-2021



*Serving others, creating places  
where people thrive.*

756 Haddon Ave.  
Collingswood, NJ 08108  
856.854.1880  
[www.kitchenandassociates.com](http://www.kitchenandassociates.com)

We're proud to support the  
**2022 New Jersey  
Planning and  
Redevelopment  
Conference.**



**TD READY  
COMMITMENT**

Member FDIC, TD Bank, N.A.



America's Most Convenient Bank®

# SPEAKERS

---

**REGAN PATTERSON, PHD**

*Transportation Equity Research Fellow, Congressional Black Caucus Foundation*

**TONY PERRY**

*Mayor, Middletown Township*

**BRIDGET PHIFER**

*Chief Executive Officer, Parkside Business & Community in Partnership (PBCIP)*

**NATALIE PINEIRO**

*Executive Director, Downtown Somerville Alliance*

**FRANK PINTO**

*President, Pinto Consulting, LLC*

**RASHAN PRAILOW**

*Founder, Think Group LLC & Co-Chair, Lead-Free NJ*

**DONNA RENDEIRO**

*Executive Director, State Planning Commission, Office of Planning Advocacy*

**RENAE REYNOLDS**

*Executive Director, Tri-State Transportation Campaign*

**TED RITTER**

*Manager, External Affairs, North Jersey Transportation Planning Authority*

**JULIO RIVERA**

*National Deputy Director of Civic Engagement, NALEO Educational Fund*

**DAVID ROBERTS, PP, AICP**

*Township Planner/Division Director - Planning & Zoning, Toms River Township*

**ZUNILDA RODRIGUEZ, AICP**

*Senior Associate, Nishuane Group*

**TANYA ROHRBACH**

*Community Planning Manager, New Jersey Future*

**PAMELA RUSSO**

*Senior Program Officer, Robert Wood Johnson Foundation*

**MIRIAM SALERNO**

*Senior Research Manager, Alan M. Voorhees Transportation Center, Rutgers University*

**MARC SALUK**

*Director, Hunterdon County Economic Development*

**JENNIFER SCHNEIDER**

*Environmental Director, Town of Secaucus*

**SAMUEL SCHROEDER, PP, AICP**

*Principal Planner, County of Hudson*

**ELEANOR SHARPE**

*Deputy Director for Planning and Zoning, Department of Planning and Development, City of Philadelphia*

**LAUREN SKOWRONSKI**

*Program Director for Community Engagement, Sustainable Jersey*

**STAN SLACHETKA, FAICP, PP**

*Planning Group Manager, T&M Associates*

# SPEAKERS

---

**SHEREYL SNIDER**

*Community Organizer,  
Urban Promise Trenton/  
East Trenton Collaborative*

**RANDALL SOLOMON**

*Executive Director, Sustainable Jersey*

**JULIA SOMERS**

*Executive Director,  
New Jersey Highlands Coalition*

**GARY SONDERMEYER**

*Vice President of Operations,  
Bayshore Recycling*

**ANNE STRAUSS-WIEDER**

*Director, Freight Planning,  
North Jersey Transportation  
Planning Authority*

**THOMAS STROWE**

*Director of Redevelopment,  
Township of Scotch Plains*

**TIM SULLIVAN**

*Chief Executive Officer, New Jersey  
Economic Development Authority*

**YOLANDA TAKESIAN**

*Principal Planner,  
Kittelson & Associates*

**DEBRA TANTLEFF**

*Founding Principal, Tantum Real Estate*

**ADAM TECZA**

*Planner & Urban Designer, FHI Studio*

**PATRICK TERBERG**

*Managing Member, TD+Partners*

## TIRED OF THE SAME OLD LAND USE PLANNING WORK?

*Looking for an exciting new opportunity to  
diversify your planning skills?*



Is seeking an individual with 3 or more years relative experience to assist with projects such as Community Development Strategies, Economic Development Plans, Grant and Funding Applications, Neighborhood Plans, Economic Impact Analyses, Comprehensive Economic Development Strategies (CEDS), and Other Related Work as Needed.

The successful candidate will have an exciting opportunity to work with a great team of professionals with disciplines covering the full spectrum of community and economic development and housing. Over the last 43 years, Triad has been instrumental in helping communities with over 1.2 Billion dollars in funding secured.

Visit our careers page on our website for more information:  
[www.triadincorporated.com/careers](http://www.triadincorporated.com/careers)

# SPEAKERS

---

## **GEORGEEN THEODORE**

*Professor, Hillier College of  
Architecture & Design, New Jersey  
Institute of Technology*

## **DEBRA THOMAS**

*Planning Board Chair,  
Borough of Raritan*

## **SERA TOLGAY, AICP**

*Senior Designer, SCAPE*

## **LAURA TORCHIO**

*Technical Advisor & Director  
of Placemaking, NV5*

## **SHERRY TRACEY**

*Managing Director, Phoenix Advisors LLC*

## **ALEXANDRA TRANMER**

*Director of Strategic Planning,  
Camoin Associates*

## **DEBRA URBAN**

*Chief of Multifamily Programs,  
New Jersey Housing and Mortgage  
Finance Agency*

## **TASHI VAZQUEZ**

*Assistant Director, Office of  
Economic & Community  
Development, City of Perth Amboy*

## **ALANA VEGA**

*Health Policy Analyst, Advocates  
for Children of New Jersey*

## **MICHAEL VENEZIA**

*Mayor, Bloomfield Township*

## **JYOTI VENKETRAMAN**

*Program Manager, New Jersey Future*

## **YVETTE VIASUS**

*Community Solar Outreach Manager,  
Solar Landscape*

## **RANJIT WALIA**

*Founder/CEO, Civic Eye Collaborative*

## **JOHN S. WATSON, JR.**

*Co-Executive Director, New Jersey  
Conservation Foundation*

## **ELNARDO WEBSTER**

*Partner, Inglesino, Webster,  
Wyciskala, & Taylor, LLC*

## **ELENA WEISSMAN**

*Regional Director - Mid-Atlantic,  
Vote Solar*

## **MICHAEL WIERZBICKI**

*Senior Project Officer, Historic  
Preservation Department, New Jersey  
Economic Development Authority*

## **SHAWN WILSON, PHD**

*Secretary, Louisiana Department  
of Transportation and Development;  
President, American Association  
of State Highway and  
Transportation Officials*

## **CATHLEEN WOLF, AICP, PP**

*Planner – Community  
Development, City of Hoboken*

## **STEVEN WRAY**

*Senior Vice President and  
Principal, Econsult Solutions, Inc.*

## **MEGHAN WREN, AICP, CFM**

*Chair, Downe Township Green Team*

McManimon, Scotland & Baumann, LLC

# CELEBRATING 50 YEARS OF SERVICE TO OUR CLIENTS

McManimon, Scotland & Baumann, LLC is celebrating the 50th Anniversary of its founding and its service of clients throughout New Jersey. Founded as Kraft & Hughes, the firm has evolved during its 50-year journey from being the first bond counsel firm in New Jersey, to today's full service, multi-disciplinary public/private law firm. Our foundation is built upon outstanding professionals coming together to bring the best they have to offer, without exception or hesitation, in service of one another and our clients. We are thankful for the opportunity over the last half-century to serve our clients and we look forward to continuing in service for many years to come.



McMANIMON • SCOTLAND • BAUMANN

NEWARK ROSELAND TRENTON NEW YORK 973.622.1800 [msbnj.com](http://msbnj.com)

# THANK YOU TO OUR PROMOTIONAL PARTNERS

**AMERICAN INSTITUTE OF ARCHITECTS, NEW JERSEY CHAPTER**

**DENSE MAGAZINE**

**DOWNTOWN NEW JERSEY**

**JERSEY WATER WORKS**

**LEAD-FREE NJ**

**NEW JERSEY BUILDERS ASSOCIATION**

**NEW JERSEY ECONOMIC DEVELOPMENT AUTHORITY**

**NEW JERSEY PACE**

**SEWAGE-FREE STREETS AND RIVERS**

**Valley Bank Proudly Supports**

## **NEW JERSEY FUTURE**

and its partners in their efforts to build  
inclusive and equitable places where people  
can live, work, and play.



© 2022 Valley National Bank. Member FDIC. Equal Opportunity Lender. All Rights Reserved. VLY5402

We have a development-oriented governing body and more available ocean-proximity real estate than any other town in New Jersey. We adjoin a major suburban area while being only one hour from the number one and number four markets in the US: NYC and Philadelphia.

# SEASIDE HEIGHTS

is rapidly growing as the place to...

## LIVE, PLAY AND INVEST.



- ✓ Multiple designated redevelopment areas
- ✓ Growing year round environment
- ✓ Ready to embrace projects from small to large
- ✓ Residential building boom
- ✓ Minutes away from 1/4 million year round residents
- ✓ One hour from NYC, Phila and AC; off GSP Exit 82

*"We have a borough government that is very oriented towards facilitating investment and to assisting any new business or any major investor coming into town with succeeding. We are a YES town! If you have a project you would like to do in a coastal community, our door is open...come and talk to us."* Seaside Heights Mayor, Anthony Vaz



Contact Borough Administrator Chris Vaz for:  
Redevelopment Information: 732-793-9100  
Borough: [www.seaside-heightsnj.org](http://www.seaside-heightsnj.org)

Tourism: [www.exit82.com](http://www.exit82.com)  
Business and Commercial Real Estate:  
[www.exit82.com/business](http://www.exit82.com/business)

# THANK YOU TO OUR SPONSORS

## TITLE



# PSEG

### ACADEMIC PARTNER

**EDWARD J. BLOUSTEIN SCHOOL  
OF PLANNING AND PUBLIC POLICY,  
RUTGERS UNIVERSITY**

### COMMUNITY BUILDER

**MARAZITI FALCON, LLP**

### MEDIA SPONSOR

**REAL ESTATE NJ**

### CLE CREDITS PARTNER

**NEW JERSEY BUILDERS ASSOCIATION**

### PLENARY

**GREENBAUM, ROWE, SMITH & DAVIS LLP**

**HACKENSACK MERIDIAN HEALTH**

**MCMANIMON, SCOTLAND & BAUMAN, LLC**

**NEW JERSEY ECONOMIC  
DEVELOPMENT AUTHORITY**

**PNC BANK**

**ROBERT WOOD JOHNSON FOUNDATION**

**ROWAN UNIVERSITY, SCHOOL OF  
EARTH AND ENVIRONMENT**

**SOLAR LANDSCAPE**

### TRACK

**DRESDNER ROBIN**

**GENOVA BURNS LLC**

**HANINI GROUP**

**INGLESINO, WEBSTER,  
WYCISKALA & TAYLOR, LLC**

**NEW JERSEY  
REDEVELOPMENT AUTHORITY**

**PHOENIX ADVISORS, LLC**

**T&M ASSOCIATES**

**TD BANK**

**VALLEY BANK**

### EXHIBIT

**AMERICAN INSTITUTE OF  
ARCHITECTS - NEW JERSEY**

**BAYSHORE FAMILY OF COMPANIES**

**H2M ARCHITECTS + ENGINEERS**

**NEW JERSEY'S CLEAN ENERGY PROGRAM**

**PS&S ENGINEERING & ARCHITECTURE**

**THA CONSULTING, INC.**



## The Future of Solar is Here.

Solar Landscape is expanding access to renewables through community solar.

Community solar allows homeowners and renters – especially lower-income residents – to power their homes with local solar energy without the hassle or expense of putting panels on their own roof.

As the leading provider of community solar in New Jersey, Solar Landscape is reducing energy costs, training a clean energy workforce, expanding energy equity, and building healthier communities – with no panels on greenfields or agricultural lands.

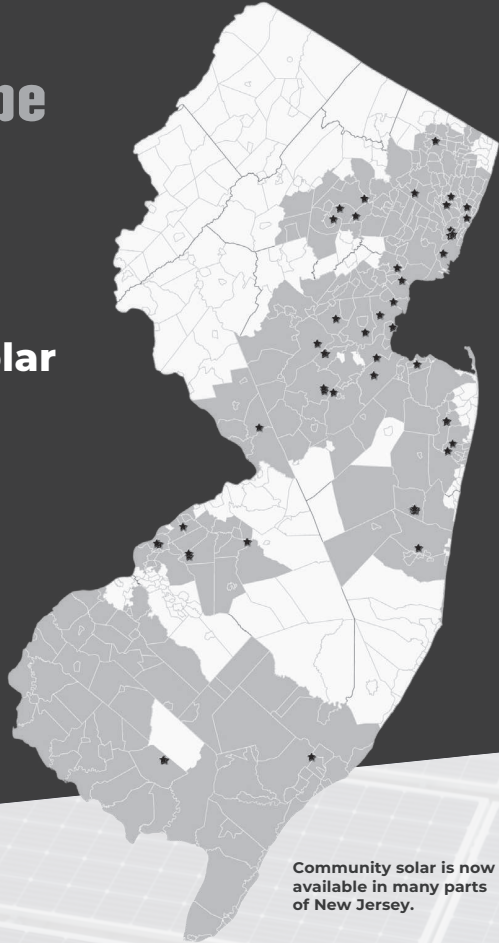

Community solar is now available in many parts of New Jersey.

## Learn More

[www.SolarLandscape.com](http://www.SolarLandscape.com) • (844)765-2769



# THANK YOU TO OUR SPONSORS

## VIRTUAL EXHIBIT

JPMONZO MUNICIPAL CONSULTING

LAND DIMENSIONS ENGINEERING

MIDATLANTIC ENGINEERING PARTNERS

PERKINS EASTMAN

RPM DEVELOPMENT GROUP

## RECEPTION

NEW BRUNSWICK DEVELOPMENT  
CORPORATION

NEW JERSEY HOUSING AND MORTGAGE  
FINANCE AGENCY

## SCHOLARSHIP

ATLANTIC REALTY DEVELOPMENT CORP.

CLARKE CATON HINTZ, PC

COLLIERS ENGINEERING & DESIGN

FIRSTENERGY FOUNDATION

KITCHEN & ASSOCIATES

NEW BRUNSWICK CITY CENTER

SEASIDE HEIGHTS BUSINESS  
IMPROVEMENT DISTRICT

WOODMONT PROPERTIES

## BREAKOUT SESSION IN-PERSON

CHIESA SHAHINIAN & GIANTOMASI PC

NEW JERSEY AMERICAN WATER

## BREAKOUT SESSION VIRTUAL

BIGGINS LACY SHAPIRO & COMPANY, LLC

NJM INSURANCE GROUP

SAM SCHWARTZ

SZAFERMAN LAKIND

## COLLEAGUE

AVALONBAY COMMUNITIES INC.

BRS INC.

COFONE CONSULTING GROUP

CREIGH RAHENKAMP & ASSOCIATES, LLC

DEWBERRY

ERIC K. SNYDER AND ASSOCIATES

FHI STUDIO

FOLEY HOAG LLP

HEYER, GRUEL & ASSOCIATES

HYLAND LEVIN SHAPIRO LLP

JGSC GROUP

NISHUANE GROUP

PHILLIPS PREISS GRYGIEL  
LEHENY HUGHES LLC

SHARBELL

SILVERMAN

THE EASTERN TRANSPORTATION COALITION

THE SPADACCINI LAW FIRM, LLC

TRIAD ASSOCIATES

TWENTYTWO PUBLIC AFFAIRS

# VISIT OUR EXHIBITORS IN THE ATRIUM!

---

AMERICAN INSTITUTE OF  
ARCHITECTS - NEW JERSEY

BAYSHORE FAMILY OF COMPANIES

DENSE MAGAZINE

EDWARD J. BLOUSTEIN SCHOOL OF  
PLANNING AND PUBLIC POLICY,  
RUTGERS UNIVERSITY

GREENBAUM, ROWE,  
SMITH & DAVIS LLP

H2M ARCHITECTS + ENGINEERS

JERSEY WATER WORKS

LEAD-FREE NJ

MARAZITI FALCON, LLP

NEW JERSEY ECONOMIC  
DEVELOPMENT AUTHORITY

NEW JERSEY FUTURE

NEW JERSEY HOUSING AND  
MORTGAGE FINANCE AGENCY

NEW JERSEY  
REDEVELOPMENT AUTHORITY

NEW JERSEY'S CLEAN

ENERGY PROGRAM

PSEG

PS&S ENGINEERING  
& ARCHITECTURE

REAL ESTATE NJ

ROWAN UNIVERSITY, SCHOOL OF  
EARTH AND ENVIRONMENT

SOLAR LANDSCAPE

THA CONSULTING, INC.

**WE STRIVE TO SERVE YOU  
AND YOUR LEGAL NEEDS**

**I**NGLESINO WEBSTER  
WYCISKALA TAYLOR, LLC  
ATTORNEYS AT LAW



600 Parsippany Rd., Suite 204 • Parsippany, NJ 07054  
Phone: (973) 947-7111 • Fax: (973) 887-2700  
[www.iwwt.law](http://www.iwwt.law)



# New Jersey Redevelopment Authority Training Institute



Now Offering

### CUSTOMIZED TRAINING

- Virtual or In-Person consultation
- We will assess your redevelopment goals & customize a course based on your needs
- Our goal is to enable your development staff to acquire skills to promote growth and knowledge of redevelopment activities in your communities
- Training will utilize a case study approach led by industry experts

### MUNICIPAL CONSULTATIONS

- Virtual or In-Person consultation
- Our goal is to provide an assessment of a specific project's feasibility and the best redevelopment approach
- Consultations are led by leading industry experts

 [www.njra.us](http://www.njra.us)    [njrarti@njra.us](mailto:njrarti@njra.us)    609 292-3739



**T&M is a proud sponsor of the 2022 NJ Planning and Redevelopment Conference**

**Join T&M's Planning Group Manager Stan Slachetka, FAICP, PP on June 16th at 2:30 PM for the session:**

**Climate Blight: Using Redevelopment to Plan for and Address Climate Change**

**Panelists will discuss of the impact of climate change on socially vulnerable populations and how redevelopment plans can be crafted to address environmental justice issues.**

**To learn more about T&M, please visit [tandmassociates.com](http://tandmassociates.com)**



## **STAFF**

**SHEENA COLLUM, MPA**  
Executive Director

## **EXECUTIVE COMMITTEE**

**CHARLES W. LATINI, JR., AICP, PP**  
President

**THOMAS G. DALLESSIO, AICP, PP, CPM, FRSA**  
Vice President of Policy

**ANGELA KNOWLES, AICP, PP**  
Vice President of Conference Services

**TOM SCHULZE, AICP, PP**  
Community Planning Assistance Program

**CAILEAN KOK, AICP, PP**  
Professional Development Officer (Cont. Ed)

**JOHN BARREE, AICP, PP**  
Professional Development Officer (Exam Prep)

**MIRAH BECKER, AICP, PP**  
Secretary

**JEFFREY WILKERSON, AICP, PP**  
Treasurer

**JESSICA GIORGIANNI, AICP, PP**  
Northeast Area Representative

**ERIC K. SNYDER, AICP, PP**  
Northwest Area Representative

**MIKE MANZELLA, AICP, PP**  
Central Area Representative

**LORISSA LUCIANI, AICP, PP**  
Southern Area Representative

**LOUIS JOYCE, AICP, PP**  
Southern Shore Area Representative

**MICHÈLE S. DELISFORT, AICP, PP**  
Redevelopment Committee Chair

**JAMES HESS, AICP, PP**  
Transportation Committee Chair

**CREIGH RAHENKAMP, PP**  
Housing Committee Chair

**TARA KENYON, AICP, PP**  
Sustainability Committee Chair

**CARLOS RODRIGUES, FAICP, PP, CNU**  
Urban Design Committee Chair

**JENNIFER FELTIS CORTESE, AICP**  
Hazard Mitigation Committee Co-Chair

**BOB KULL, AICP, PP**  
Hazard Mitigation Committee Co-Chair

**MAURA FENNESSY**  
At-Large Member

**CHARLES HEYDT, AICP, PP**  
At-Large Member

**DAVID LISTOKIN, AICP, PP**  
Faculty Liaison (Bloustein)

**KEVIN KEENAN, PH.D., AICP**  
Faculty Liaison (Rowan)

**KYRILLOS GIRGIS**  
Student Representative

**BOARD OF TRUSTEES**

**KATHLEEN T. ELLIS**

**Chair**

Kathleen Ellis Strategic Solutions LLC

**MEISHKA MITCHELL**

**Vice Chair**

Emerald Cities Collaborative

**M. COURTNEY McCORMICK ESQ.**

**Secretary**

PSEG

**TODD A. GOMEZ**

**Treasurer**

Bank of America

**WILLIAM E. BEST**

PNC Bank

**JAY BIGGINS**

Biggins Lacy Shapiro & Company, LLC

**LAUREEN BOLES**

E4Progress, LLC

**CHRISTOPHER A. BROWN**

City of Hoboken

**HENRY A. COLEMAN PH.D.**

Edward J. Bloustein School of Planning and Public Policy, Rutgers University

**AMY CRADIC**

New Jersey Resources

**LAWRENCE M. DIVIETRO JR.**

Land Dimensions Engineering

**KENNETH M. ESSER, JR.**

Hackensack Meridian Health

**JAMES G. GILBERT**

Merrill Lynch (*retired*)

**ROBERT S. GOLDSMITH ESQ.**

Greenbaum Rowe Smith & Davis LLP

**ANDREW HENDRY**

JCP&L

**JANE M. KENNY**

The Whitman Strategy Group LLC

**SUSAN S. LEDERMAN PH.D.**

Kean University (*emerita*)

**JOSE LOZANO**

Hackensack Meridian Health

**TENISHA N. MALCOLM-WINT**

Urban Mayors Policy Center, John S. Watson Institute for Urban Policy and Research, Kean University

**JOSEPH J. MARAZITI JR. ESQ.**

Maraziti Falcon LLP

**MARK MAURIELLO**

Eggedwood Properties

**GUALBERTO (GIL) MEDINA**

CBRE Brokerage Services

**DAVID F. MOORE**

New Jersey Conservation Foundation (*retired*)

**KENDRA F. MORRIS**

Veolia North America

**PAMELA H. MOUNT**

Terhune Orchards

**INGRID W. REED**

New Jersey Future *Senior Fellow, Director (retired)* New Jersey Project, Eagleton Institute of Politics, Rutgers University

**WANDA I. SAEZ**

Wells Fargo & Company

**STEPHEN A. SANTOLA ESQ.**

Woodmont Properties

**BRIAN TRELSTAD**

Bridges Fund Management

**MADELINE (MADDY) URBISCH**

Ørsted

**JENNIFER G. VELEZ**

Horizon Blue Cross Blue Shield of New Jersey

**STAFF**

**PETER KASABACH**

**Executive Director**

**GARY BRUNE**

**Senior Policy Advisor**

**BRIANNE CALLAHAN**

**Stormwater Manager**

**DEANDRAH CAMERON**

**Policy Manager**

**RON DUKES**

**Manager of Finance and Administration**

**PATRICIA DUNKAK**

**Development and Outreach Coordinator**

**TIM EVANS**

**Director of Research**

**PAULA FIGUEROA-VEGA**

**Program Manager**

**MICHELE GLASSBURG**

**Director of Development and Outreach**

**KIMBERLEY IRBY**

**Policy Manager**

**MORIAH KINBERG**

**Community Outreach Manager**

**LE'SANTHA NAICKER**

**Policy and Program Coordinator**

**HANNAH REYNOLDS**

**Communications Specialist**

**TANYA ROHRBACH**

**Community Planning Manager**

**ANDREA SAPAL**

**Program Associate**

**DIANE SCHRAUTH**

**Policy Director**

**HEATHER SORGE**

**Program Manager, Lead-Free NJ**

**CHRIS STURM**

**Senior Advisor**

**JYOTI VENKETRAMAN**

**Program Manager**

**ALYSSA ZABINSKI**

**Digital Communications Coordinator**

# SPONSORS

## TITLE SPONSOR



# PSEG

**ACADEMIC  
PARTNER**



## RUTGERS

Edward J. Bloustein School  
of Planning and Public Policy

**COMMUNITY  
BUILDER**



**MEDIA  
SPONSOR**



**CLE CREDITS  
PARTNER**



**New Jersey  
Builders Association**



Wireless access is available

Network: @Hyatt\_Meeting

Username: **NJPRC22** Password: **NJPRC22**

---

Join the conversation! Tag New Jersey Future and APA New Jersey and use #NJPRC22